

## BUILDING FACT SHEET: OHIO AGRICULTURE CENTER

### BUILDING OVERVIEW

This innovative building, set for completion in summer 2026, features built-in kitchens, dining space, meeting rooms, and more than 100,000 square feet of clear-span, multi-use convention space.

- Meeting Rooms – 10
- Exhibition Hall Space – 100,760 square feet
- Total square footage - 177,491 square feet
- Building maximum occupancy – 6,500

#### Building Exterior



#### Exhibit Hall Space (40% shown)



#### Dining Hall



#### Hall to Meeting Rooms



## MEETING ROOMS

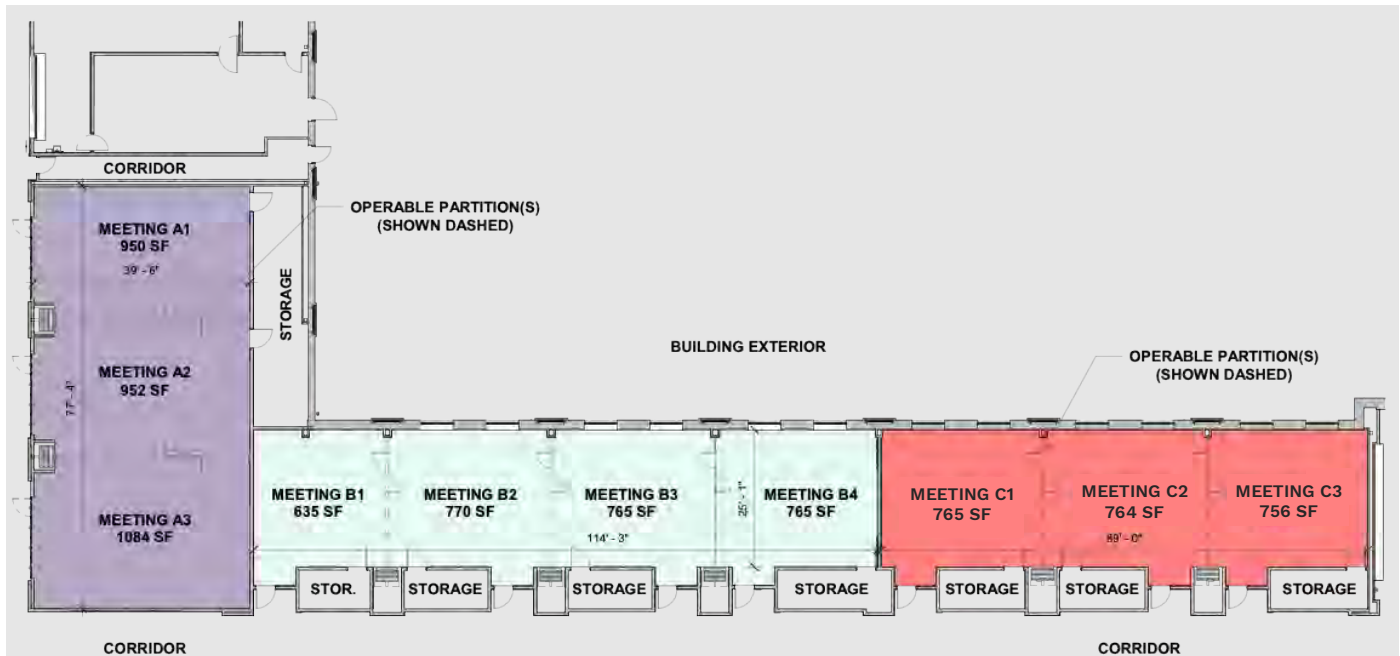

Meeting Room	Square Footage	Dimensions and any obstructions, if necessary, listed	Capacity
<b>Meeting Rooms near dining combined</b>	<b>3,014 SF</b>	<b>39'-6" W x 77'-4" L</b> <b>Operable wall closet</b>	<b>Theatre style - 272 occupants</b> <b>Banquet style - 192 occupants</b> <b>Classroom style -96 occupants</b>
Meeting room A1 (125)	950 SF	39'-6" W x 24'-3" L Operable wall closet	Theatre style - 66 occupants Banquet style - 48 occupants Classroom style-32 occupants
Meeting room A2 (126)	952 SF	39'-6" W x 24'-7 1/2" L Operable wall closet	Theatre style - 66 occupants Banquet style - 48 occupants Classroom style-32 occupants
Meeting room A3 (127)	1,084 SF	39'-6" W x 27'-8 1/2" L Operable wall closet	Theatre style - 66 occupants Banquet style - 64 occupants Classroom style-32 occupants
<b>Meeting rooms in Prefunction Hall combined (B1-B4)</b>	<b>B1-B4 2,972 SF</b>	<b>25'-1" W x 114'-3" L</b>	<b>B1-B4 Theatre style - 288 occ</b> <b>B1-B4 Banquet style - 144 occ</b> <b>B1-B4 Classroom style -144 occ</b>
Meeting room B1 (130)	635 SF	25'-1" W x 24'-3" L	Theatre style - 57 occupants Banquet style - 32 occupants Classroom style -28 occupants

Meeting room B2 (132)	770 SF	25'-1" W x 29'-7" L	Theatre style – 57 occupants Banquet style – 40 occupants Classroom style –28 occupants
Meeting room B3 (134)	765 SF	25'-1" W x 29'-4" L	Theatre style – 57 occupants Banquet style – 40 occupants Classroom style –28 occupants
Meeting room B4 (136)	765 SF	25'-1" W x 29'-4" L	Theatre style – 57 occupants Banquet style – 40 occupants Classroom style –28 occupants
<b>Meeting rooms in Prefunction Hall combined (C1-C3)</b>	<b>B5-B7 2,316 SF</b>	<b>25'-1" W x 89'-0" L</b>	<b>B5-B7 Theatre style – 216 occ</b> <b>B5-B7 Banquet style – 112 occ</b> <b>B5-B7 Classroom style –84 occ</b>
Meeting room C1 (138)	765 SF	25'-1" W x 29'-4" L	Theatre style – 57 occupants Banquet style – 40 occupants Classroom style –28 occupants
Meeting room C2 (140)	764 SF	25'-1" W x 29'-4" L	Theatre style – 57 occupants Banquet style – 40 occupants Classroom style –28 occupants
Meeting room C3 (142)	756 SF	25'-1" W x 29'-0" L	Theatre style – 57 occupants Banquet style – 40 occupants Classroom style –28 occupants
<b>Hours available</b>	7 a.m. – 10 p.m.		
<b>Floor load capacity (if limited)</b>	<p>Meeting Rooms Dining Area Combined Max Capacity = 431 Meeting Rm A1 MAX=136, Meeting Rm A2 MAX=136, Meeting Rm A3 MAX=155.</p> <p>Meeting Rooms B1-B4 Combined Max Capacity = 425 Meeting Rm B1 MAX=92, Meeting Rm B2 MAX=111, Meeting Rm B3 MAX=111, Meeting Rm B4 MAX=111.</p> <p>Meeting Rooms B5-B7 Combined Max Capacity = 332 Meeting Rm B5 MAX=110, Meeting Rm B6 MAX=112, Meeting Rm B7 MAX=110</p>		
<b>Ceiling height</b>	<p>Meeting Rooms A1- A3 = 13'-6" Soffit (lowest point of ceiling).</p> <p>Meeting Rooms B1-B7 = 14'-0" Soffit (lowest point of ceiling).</p>		
<b>Lighting capabilities</b>	<p>Zoned &amp; Dimmable LED Lighting Control (Zoned per divided meeting room).</p> <p>Daylight Harvesting (Auto Dimmed) lighting zones at meeting rooms with exterior windows. Turned off by occupancy sensor after 20 minutes.</p>		
<b>Utility locations</b>	Floor recessed outlet box w/ data-(2) per meeting room when meeting rooms are separated/divided.		
<b>Overhead door(s)</b>	N/A		
<b>Loading docks</b>	Location: Southwest corner of Expo Hall		
<b>Built-in technology</b>	<ol style="list-style-type: none"> <li>1. Ceiling projector</li> <li>2. Ceiling projector screen (electrically operated, recessed, tab tensioned)</li> </ol>		

	<ul style="list-style-type: none"> <li>3. Wall mounted wired HDMI</li> <li>4. Wireless collaboration appliance (Wireless HDMI)</li> <li>5. Ceiling microphone arrays (for Teams/Zoom)</li> <li>6. Front and rear cameras (for Teams/Zoom)</li> <li>7. Wired and wireless handheld microphones</li> <li>8. Wall mounted touch panel (inside room for control)</li> <li>9. Room scheduling touch panel (outside room for scheduling)</li> <li>10. Lighting, Window Shade, and Screen control</li> <li>11. Document camera at Lectern</li> <li>12. Automated Room Combining (partition wall sensor)</li> <li>13. Wired data in floor boxes</li> <li>14. Dedicated wall mounted AV cabinet in the storage room</li> <li>15. Note: lecterns not available.</li> </ul>
<b>Rate</b>	Meeting Rooms- \$300 ea.

## EXHIBITION HALL SPACE

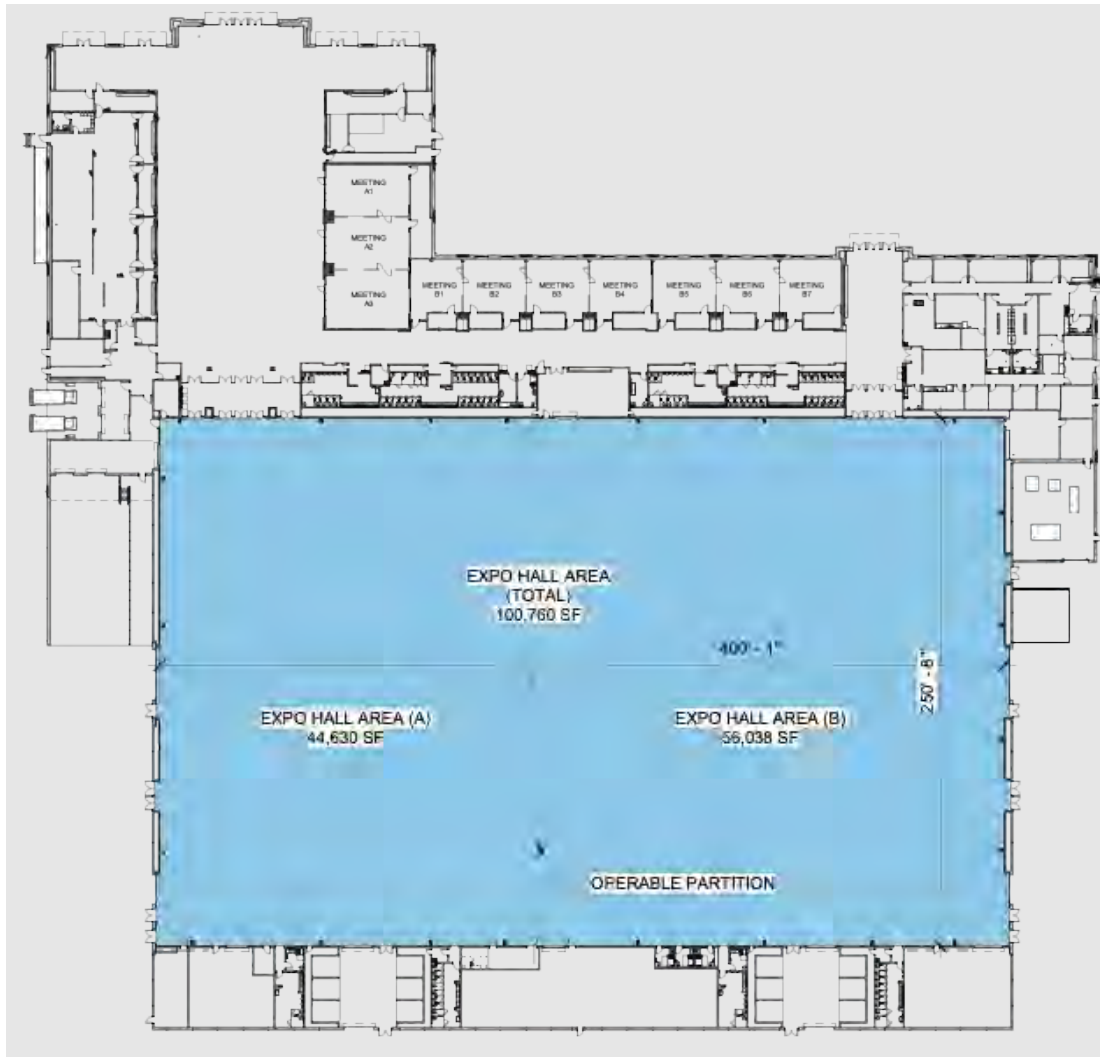

Space	Square Footage	Dimensions and any obstructions, if necessary, listed	Capacity
Entire Hall	100,760 SF	250'-8" W x 400'-1" L No Obstructions	Theatre style – 6,000 Banquet style – 3,876 Classroom style – 2,880
Hall A - 40% of Hall	44,630 SF (South of Operable Wall)	250'-8" W x 177'-3" L No Obstructions	Theatre style – 3,627 Banquet style – 2,325 Classroom style – 1,512
Hall B - 60% of Hall	56,038 SF (North of Operable Wall)	250'-8" W x 222'-5" L No Obstructions	Theatre style – 2,888 Banquet style – 1,550 Classroom style – 1,176



<b>Hours available</b>	7 a.m. – 10 p.m.
<b>Floor load capacity (if limited)</b>	6500 MAX Occupancy
<b>Ceiling height</b>	31'-0" Clear to bottom of joists. 30'-0" Clear to bottom of operable wall bulkhead (operable wall bulkhead/soffit is 6'-4" wide at the top of the operable wall)
<b>Lighting capabilities</b>	Zoned & Dimmable LED Lighting Control (Zoned per east/west light row). Manual on to 100% by local control station. Option to manual ON/OFF/DIM override relay panel for max of 2 hours using local switch or control station. Auto off by relay panel scheduling.
<b>Utility locations</b>	<p>16" Drains w/ removable sediment bucket located around the Expo Hall.</p> <p>400 AMP, 208/120 VOLT, 3 PHASE BUSDUCT AT BOTTOM CHORD OF JOIST (31'-0" A.F.F.) – 100 AMP, 208/120 VOLT, 3 PHASE FUSED BUSPLUG ON BUSDUCTS, 4 PER BUSDUCT RUN--<b>104</b> TOTAL BUSPLUGS THROUGHOUT THE EXPO HALL SPACE.</p> <p>(19 TOTAL) 100 AMP, 208/120 V, PIN &amp; SLEEVE RECEPTACLES LOCATED AT GROUND LEVEL PERIODICALLY AROUND THE PERIMETER OF THE EXPO HALL</p> <p>(7 TOTAL) 100 AMP, 480/277 V, PIN &amp; SLEEVE RECEPTACLES LOCATED AT GROUND LEVEL PERIODICALLY AROUND THE PERIMETER OF THE EXPO HALL</p>
<b>Overhead door size and location</b>	<p>South Elev: (1) 24'-0"W x 20'-0"H OHD &amp; (1) 14'-0"W x14'-0"H OHD to exterior.</p> <p>North Elev: (1) 24'-0"W x 20'-0"H OHD &amp; (1) 14'-0"W x14'-0"H OHD to exterior.</p> <p>South Elev: (2) 14'-0"W x14'-0"H OHD to the exterior through the wash bays.</p>
<b>Loading docks</b>	Loading dock is accessed at the southwest corner of the Expo Hall space via (1) 14'-0"W x14'-0"H OHD & (1) 4'-0"W x 7'-0"H Man door/Swing
<b>Built-in technology</b>	<p>EXPO Hall Sound System:</p> <ol style="list-style-type: none"> <li>1. Ceiling Speakers</li> <li>2. Ceiling Subwoofers</li> <li>3. Wireless mics (16 channels with 16 mics total)</li> <li>4. Wired microphones (16 total)</li> <li>5. Touch panel (in chair storage room)</li> <li>6. Sound system cabinet (in chair storage room)</li> <li>7. System is zoned into 2 partitions</li> </ol>

	8. NOTE: THERE IS NO VIDEO IN THIS SPACE
<b>Rate</b>	Entire Building- \$9,500 North Hall- \$6,000 South Hall- \$4,000

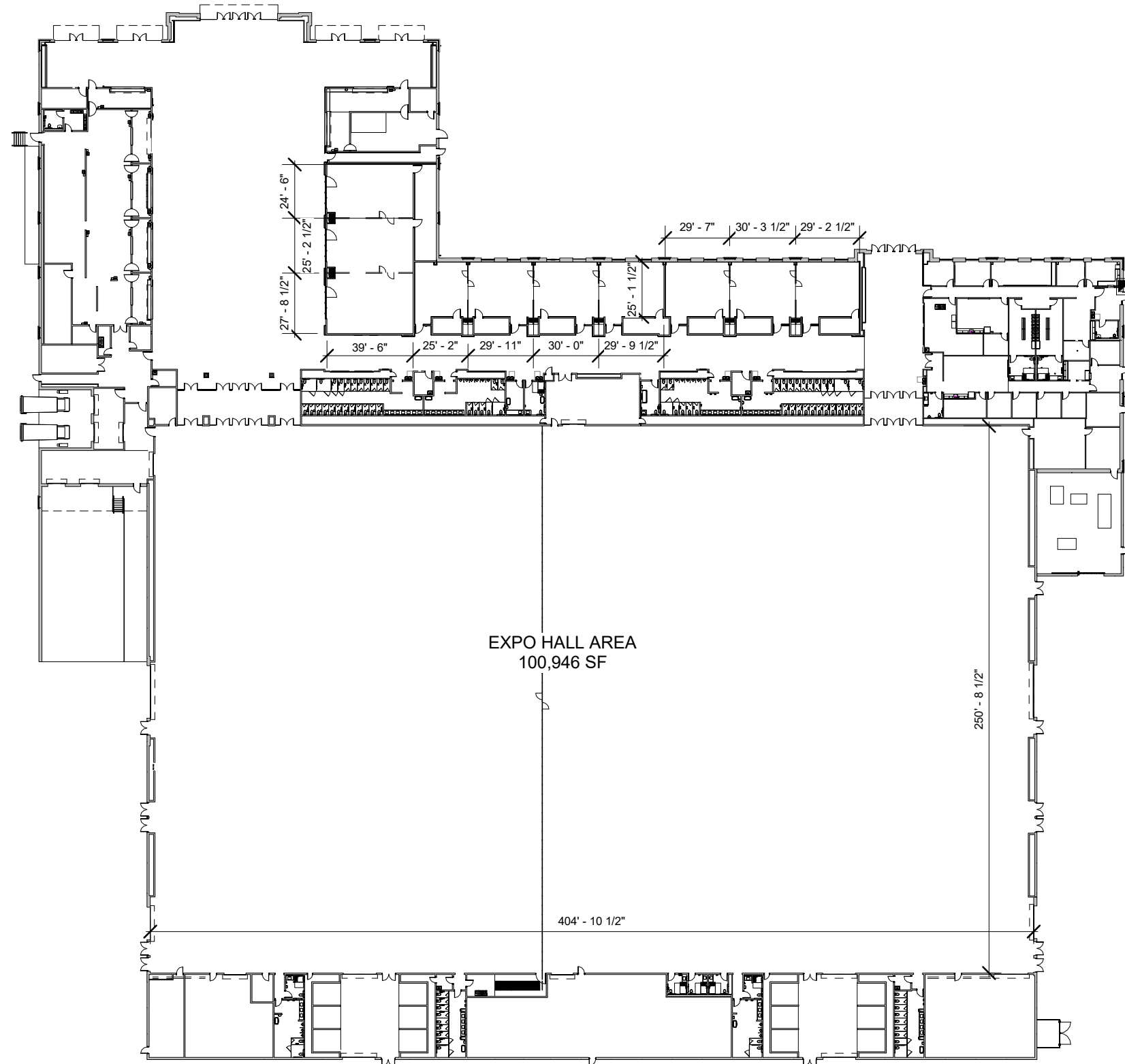



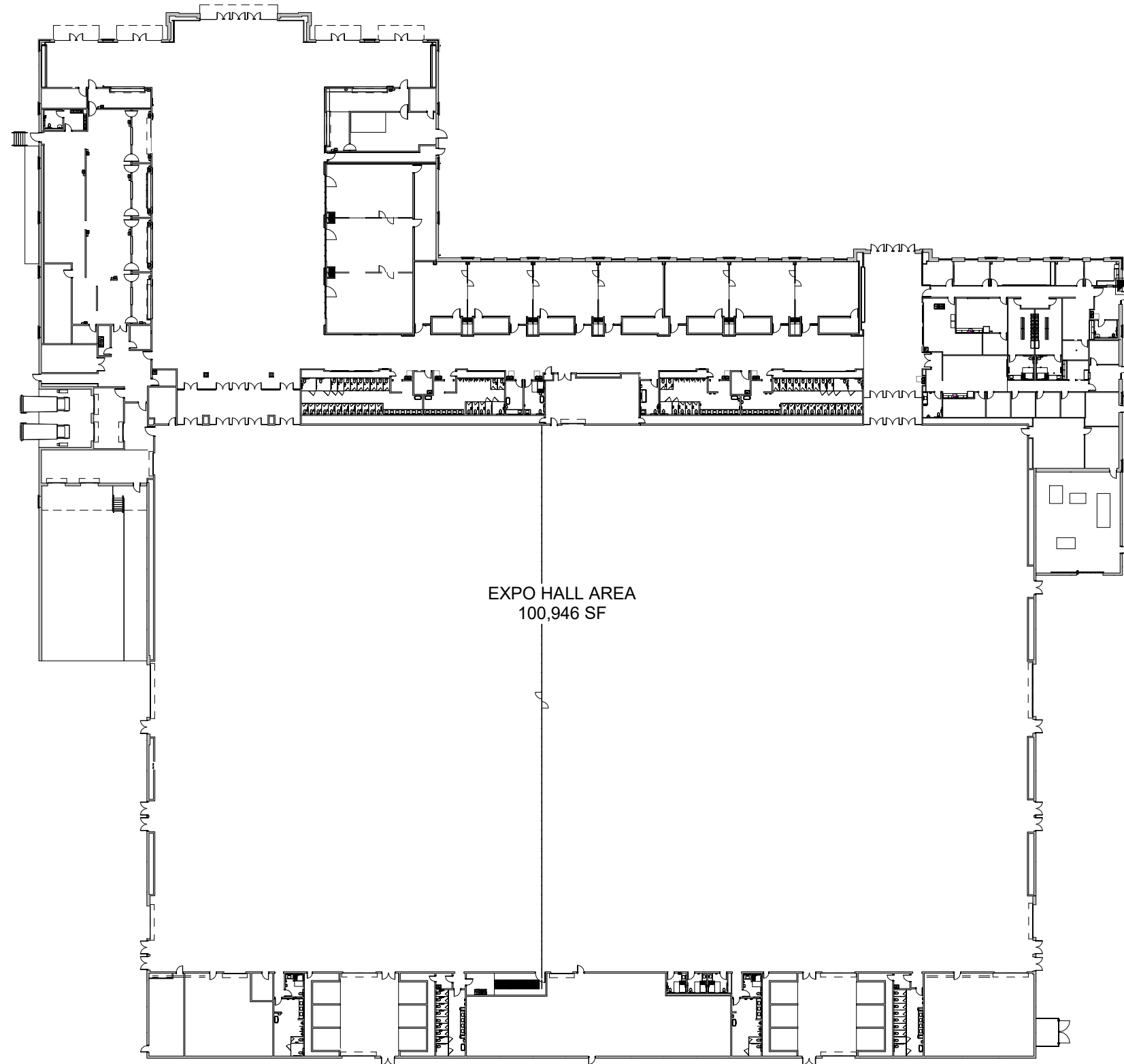

## EVENT PLANS

<b>HORSE SHOW</b>	546, 10'x10' Stalls
<b>HORSE SHOW</b>	572, 9'-6"x9'x6" Stalls
<b>EXPO BOOTHS</b>	520, 10'x10' Booths
<b>INDOOR TRACK</b>	200m Banked Running Track
<b>CONCERT</b>	6,000 - 8,000 Seats
<b>BASKETBALL</b>	5 Courts (Center Court)
<b>BASKETBALL</b>	8 Courts (Maximum)
<b>GYMNASTICS</b>	Men, Women, Rhythmic, and Trampoline
<b>VOLLEYBALL</b>	14 Courts

## MULTIPURPOSE AG BUILDING

<b>INDOOR SOCCER</b>	3 Pitches
<b>CHEERLEADING</b>	22 Mats
<b>FENCING</b>	17 Pistes
<b>BOXING</b>	10 Fields of Play
<b>TAEWKWONDO</b>	8 Fields of Play
<b>PICKELBALL</b>	24 Courts
<b>TABLE TENNIS</b>	30 Fields of Play
<b>WEIGHTLIFTING</b>	12 Fields of Play
<b>WRESTLING</b>	12 Fields of Play



EVENT PLANS

Horse Show, 9'-6"x9'-6" Stalls

- + 572 stalls
- + 12 wash stalls
- + 1:47 wash ratio

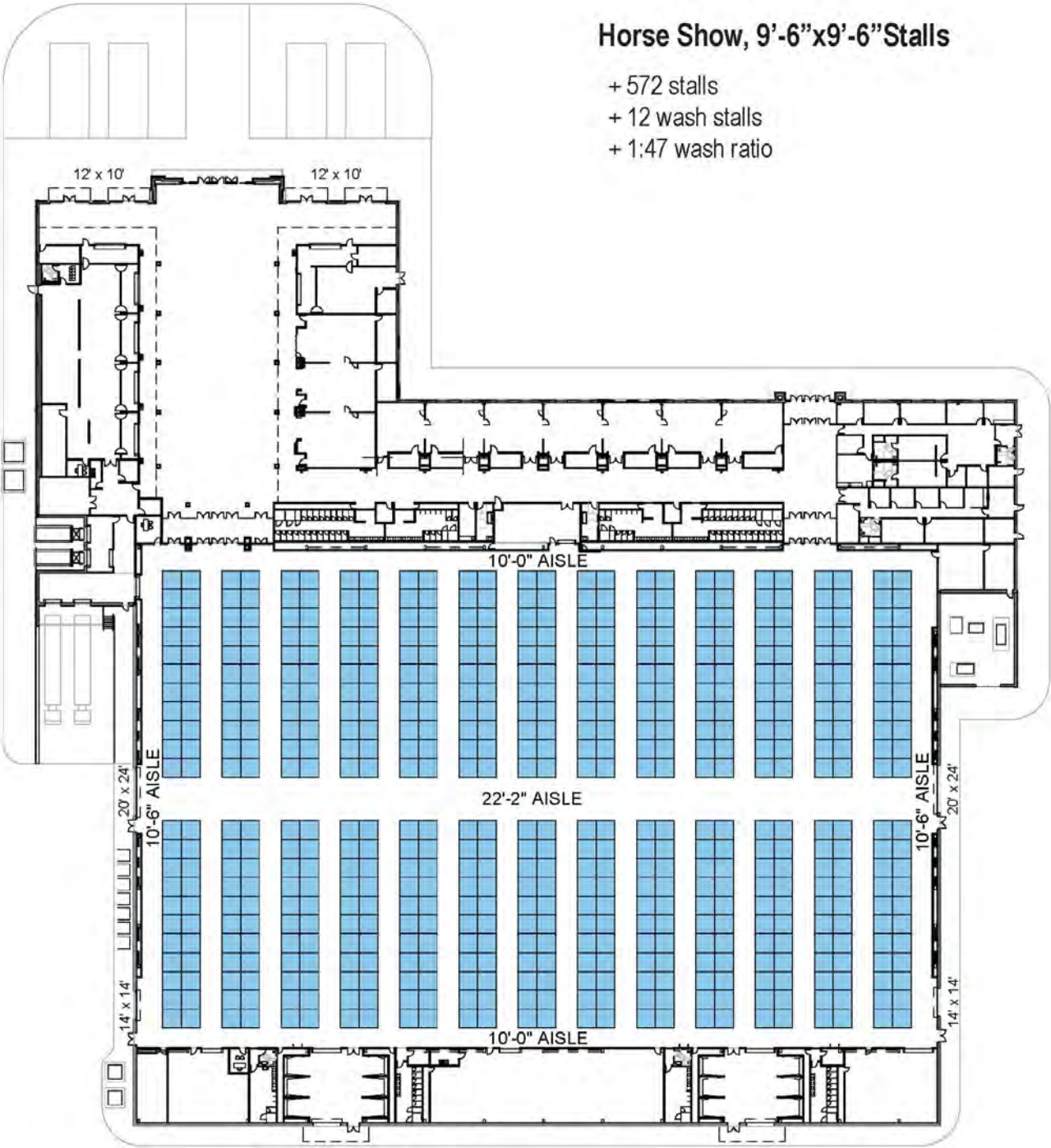

MULTIPURPOSE AG BUILDING

Horse Show, 10'x10' Stalls

- + 546 stalls
- + 12 wash stalls
- + 1:45 wash ratio

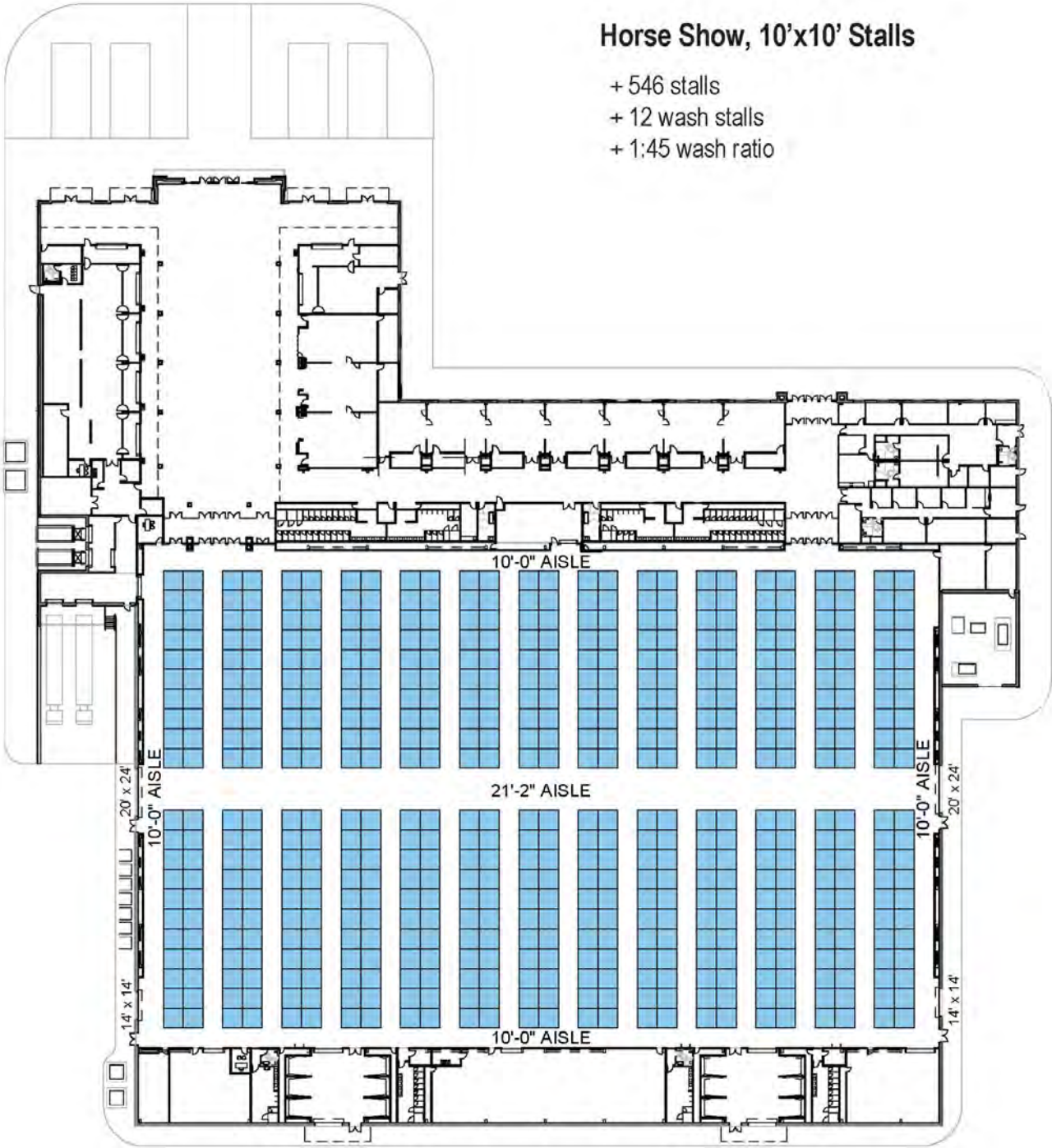



EVENT PLANS

Expo Booths

+ 520 booths at 10'x10'

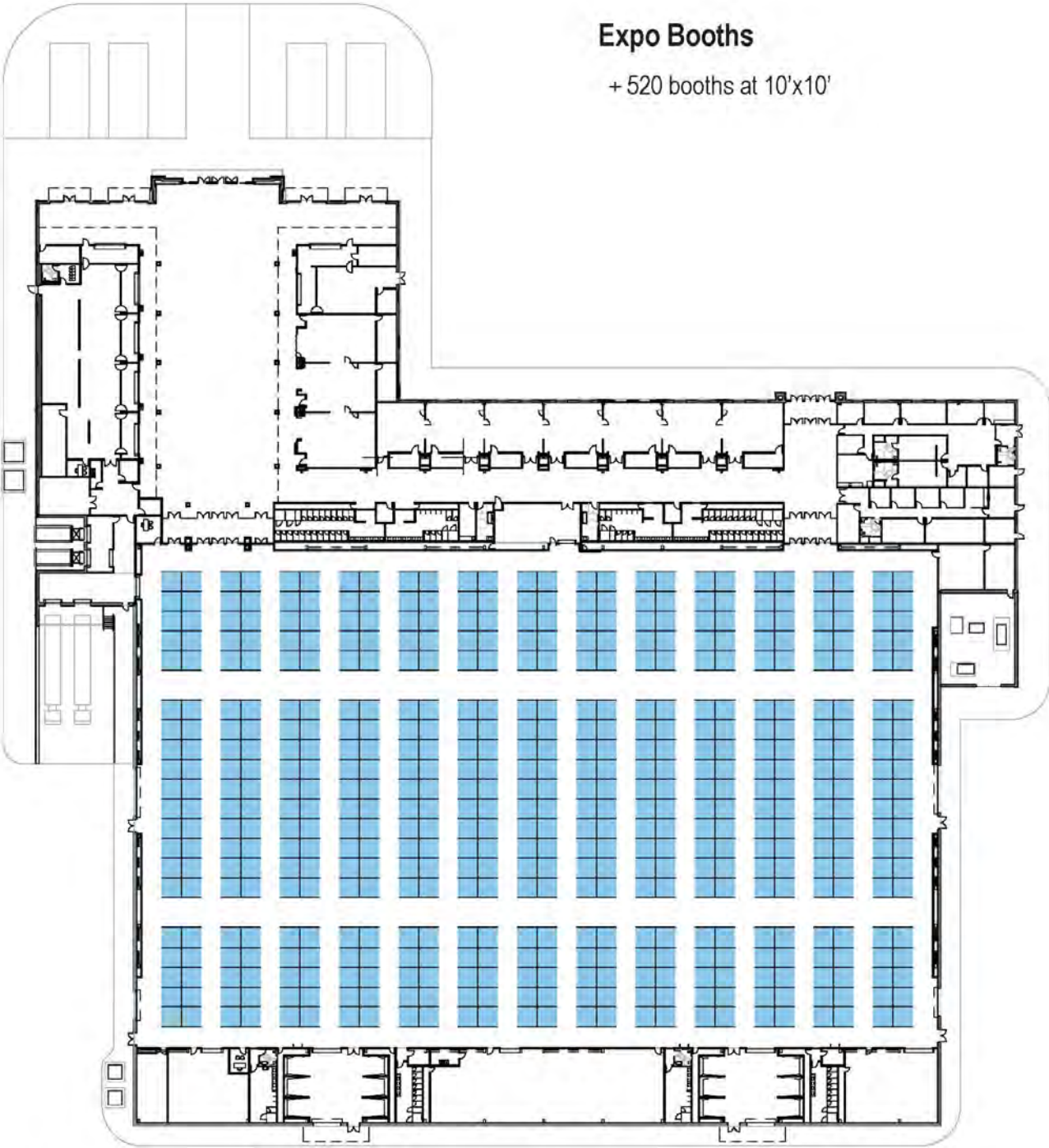

MULTIPURPOSE AG BUILDING

Indoor Track

- + 200m banked track
- + 1 sprint track
- + 2 high jump bars and mats
- + 2 pole vault runways
- + 2 long/triple jump runways
- + 1 shotput ring
- + 1 warm-up track

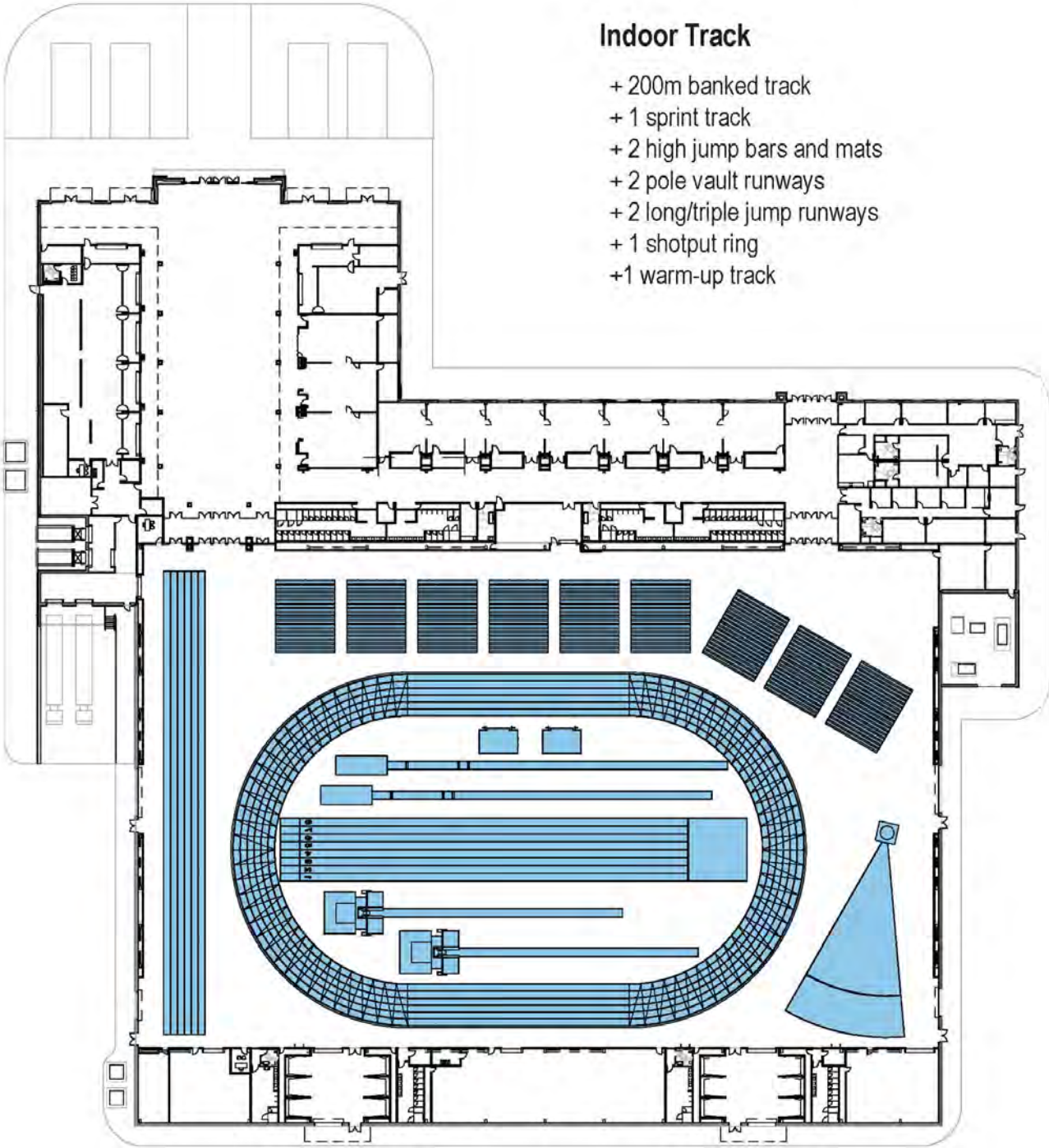



EVENT PLANS

Concert, 6k

- + 6,000 seats
- + 1 stage
- + 1 sound control booth

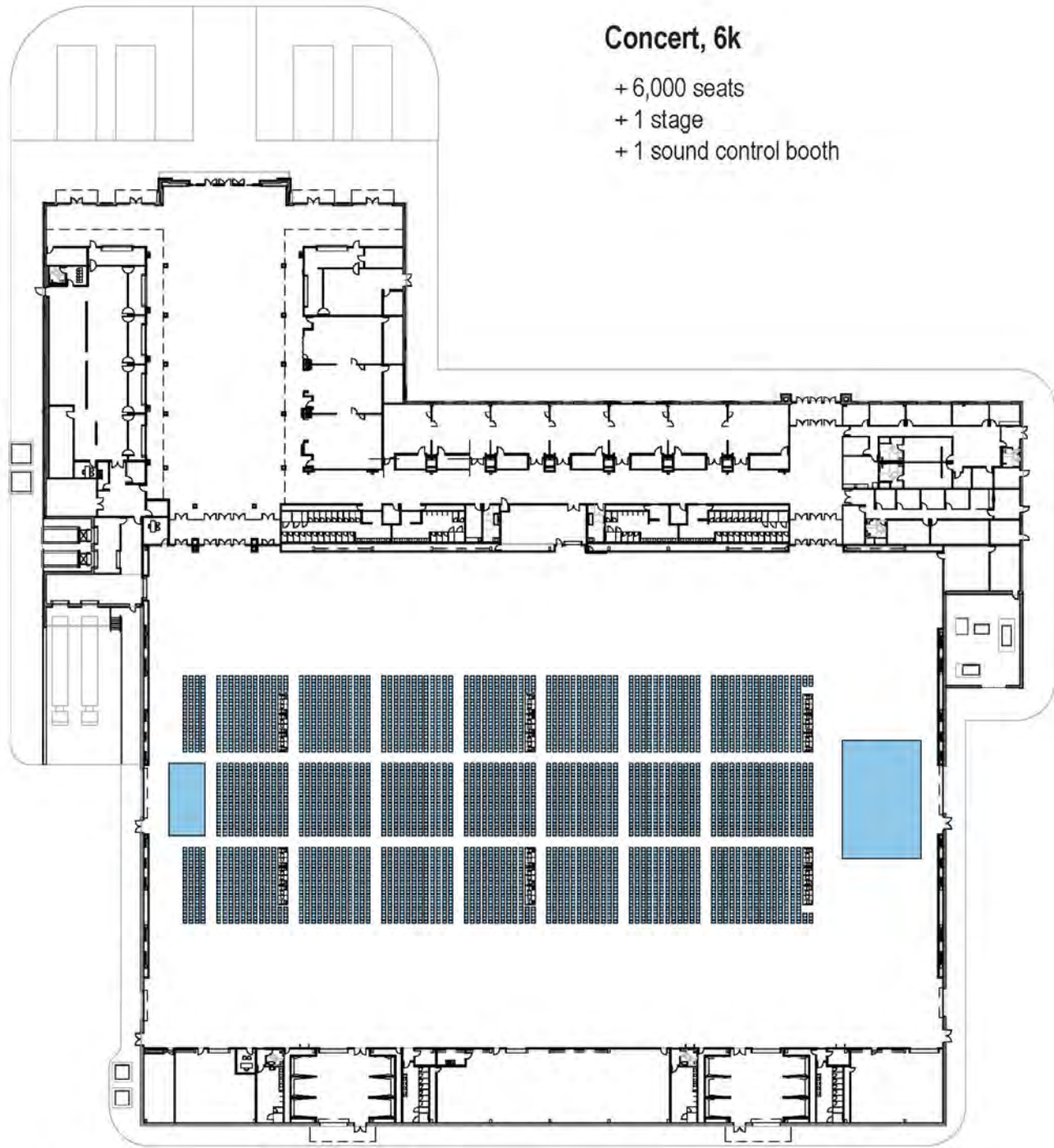

MULTIPURPOSE AG BUILDING

Concert, 8k

- + 8,000 seats
- + 1 stage
- + 1 sound control booth

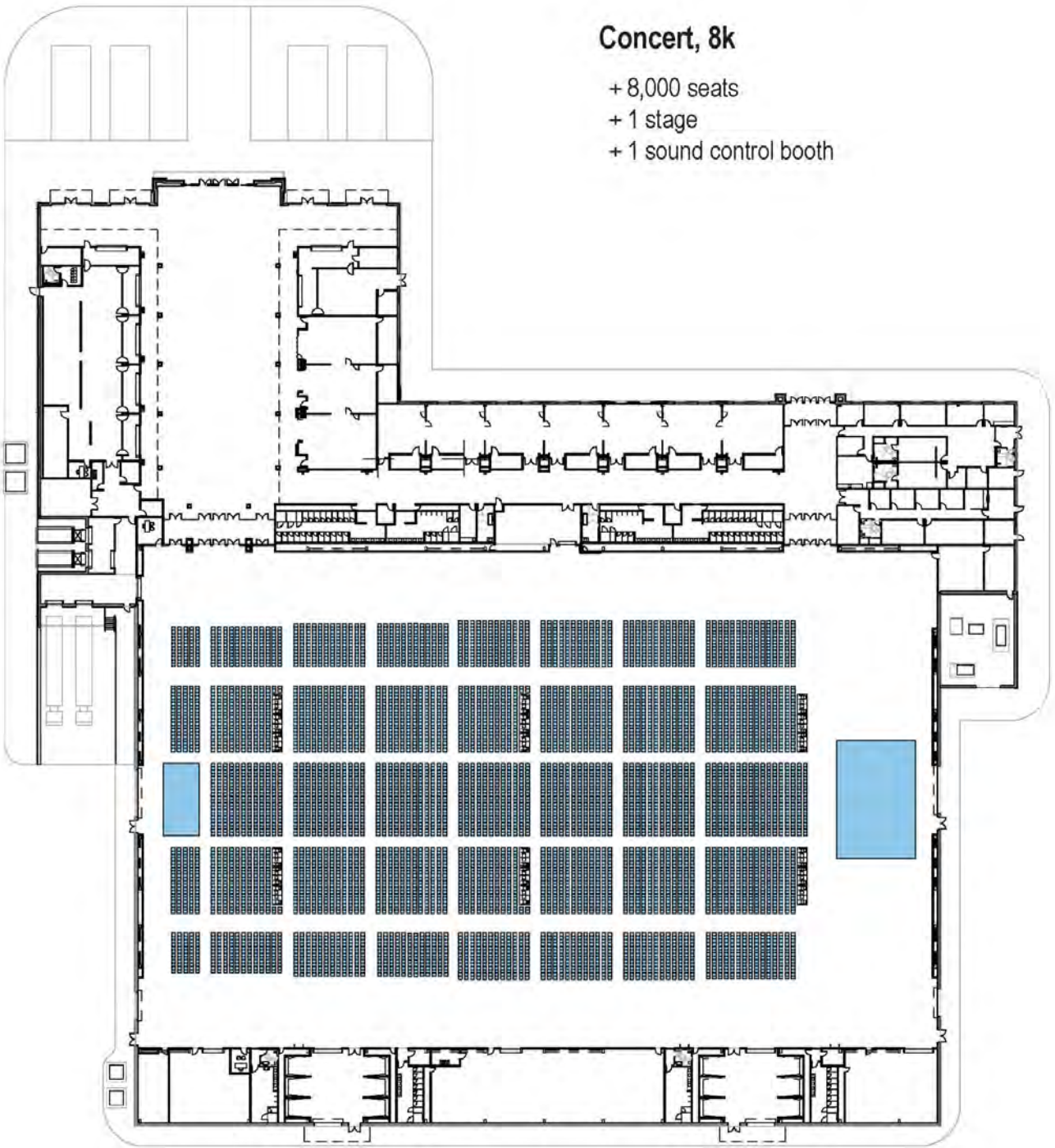



EVENT PLANS

Basketball, Championship Court

- + 5 courts
- + 840 seats at the championship court
- + 280 seats per secondary court
- + 1,960 total seats

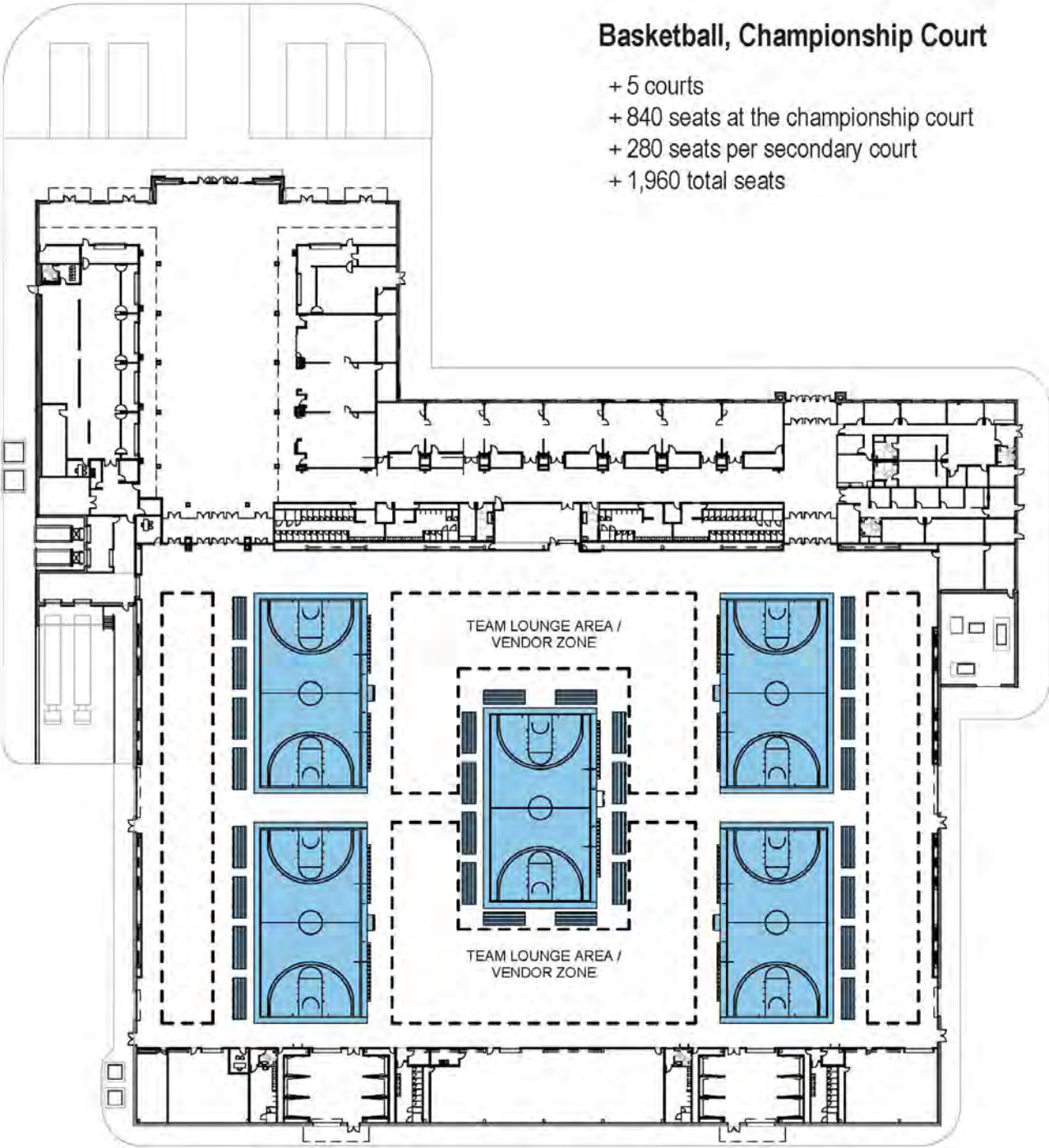

MULTIPURPOSE AG BUILDING

Basketball, Maximum Courts

- + 8 courts
- + 280 seats per court
- + 2,240 total seats

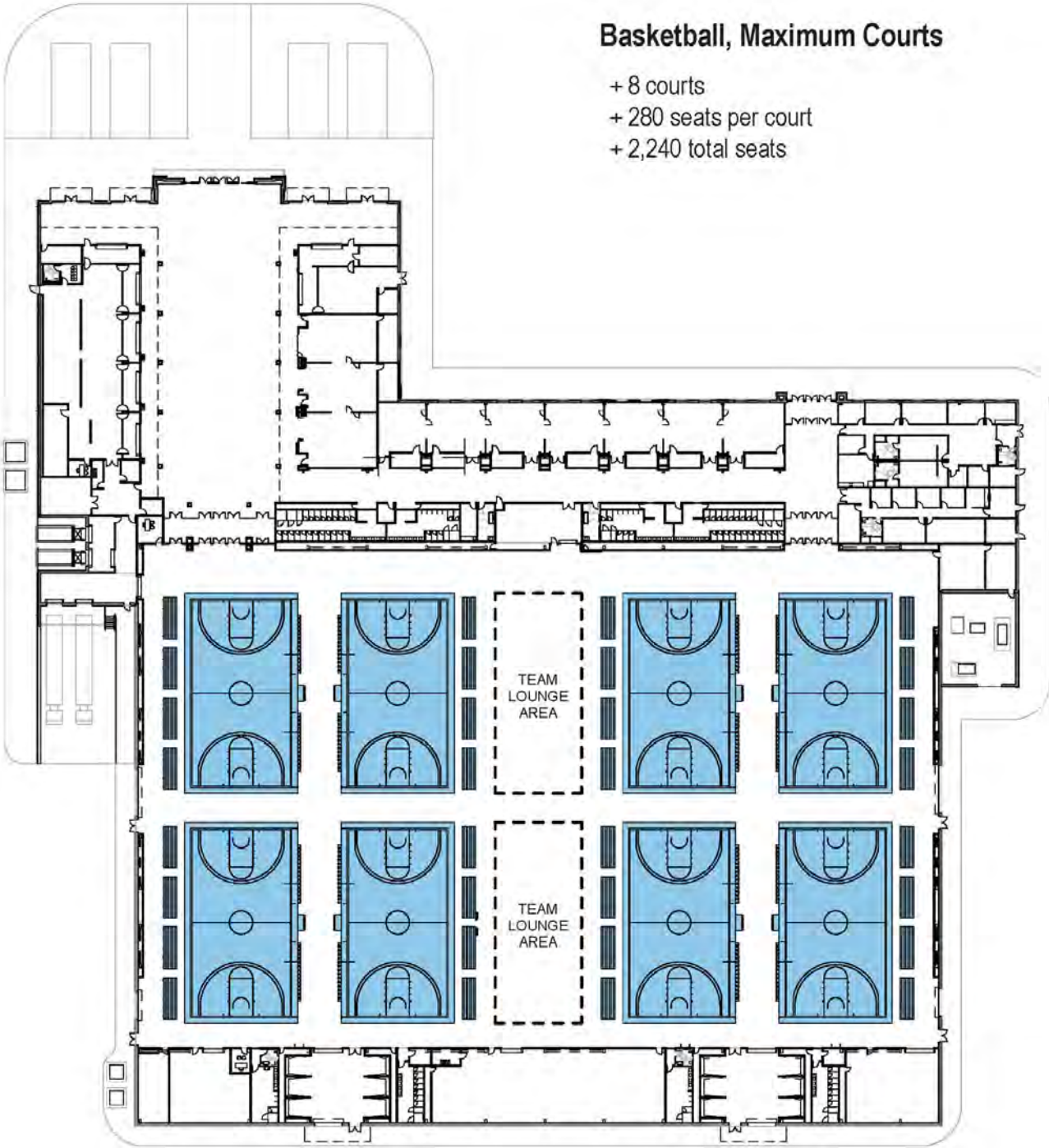



EVENT PLANS

Gymnastics, Men

- + 2 competition layouts
- + 980 seats per layout
- + 1,960 seats total

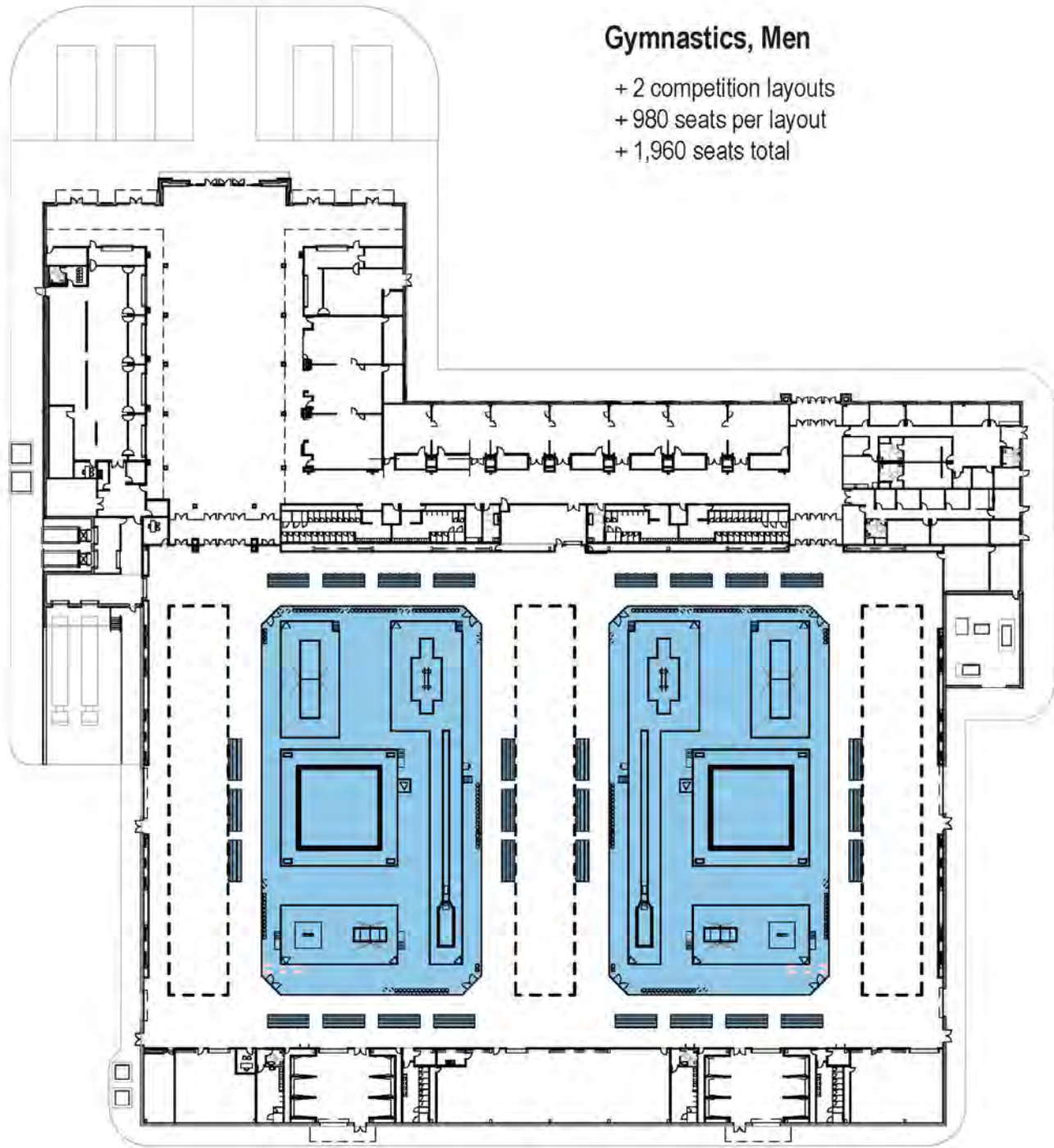

MULTIPURPOSE AG BUILDING

Gymnastics, Women

- + 2 competition layouts
- + 980 seats per layout
- + 1,960 seats total

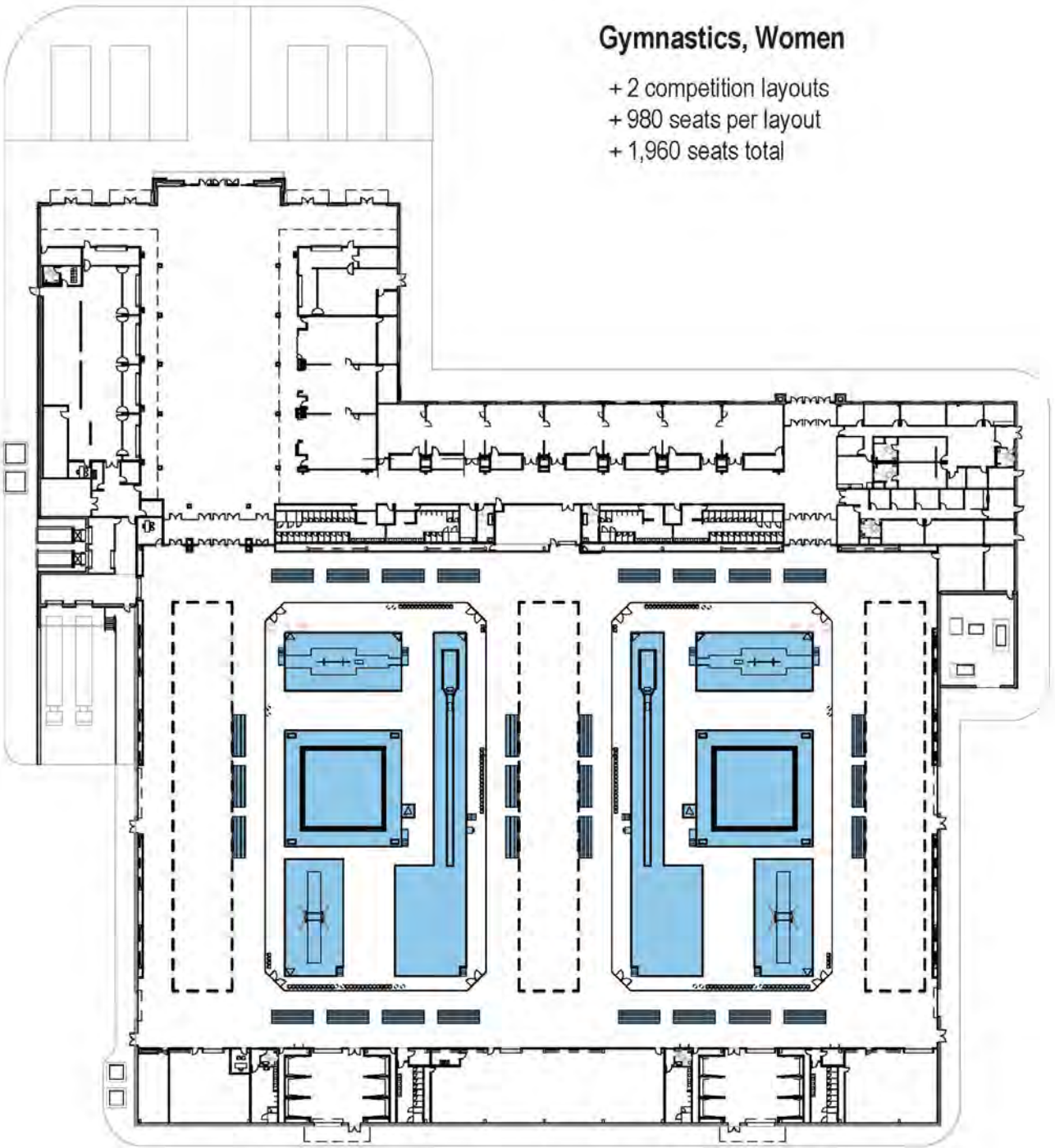



EVENT PLANS

Gymnastics, Rhythmic

- + 2 competition layouts
- + 980 seats per layout
- + 1,960 seats total

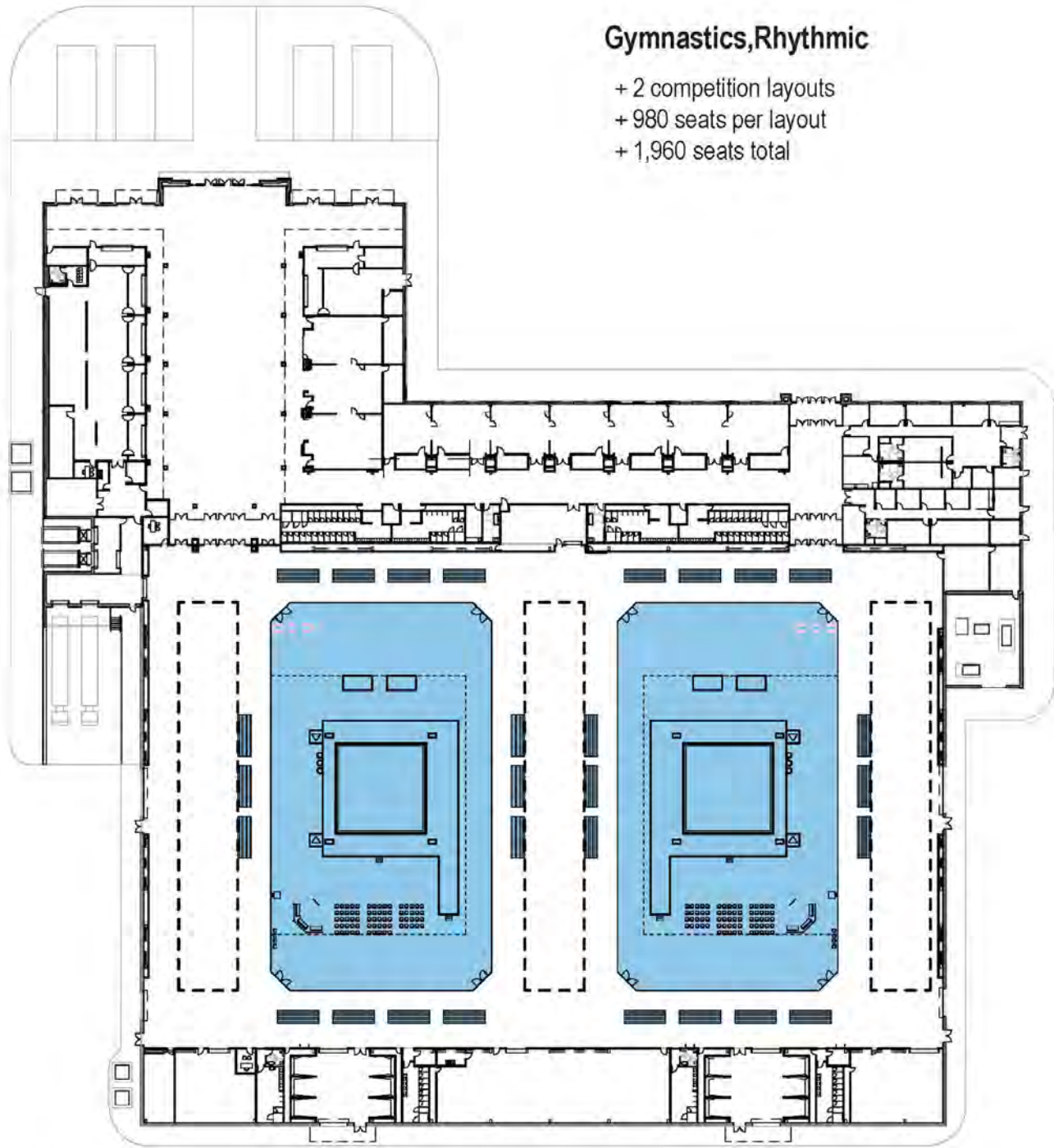

MULTIPURPOSE AG BUILDING

Gymnastics, Trampoline

- + 2 competition layouts
- + 980 seats per layout
- + 1,960 seats total

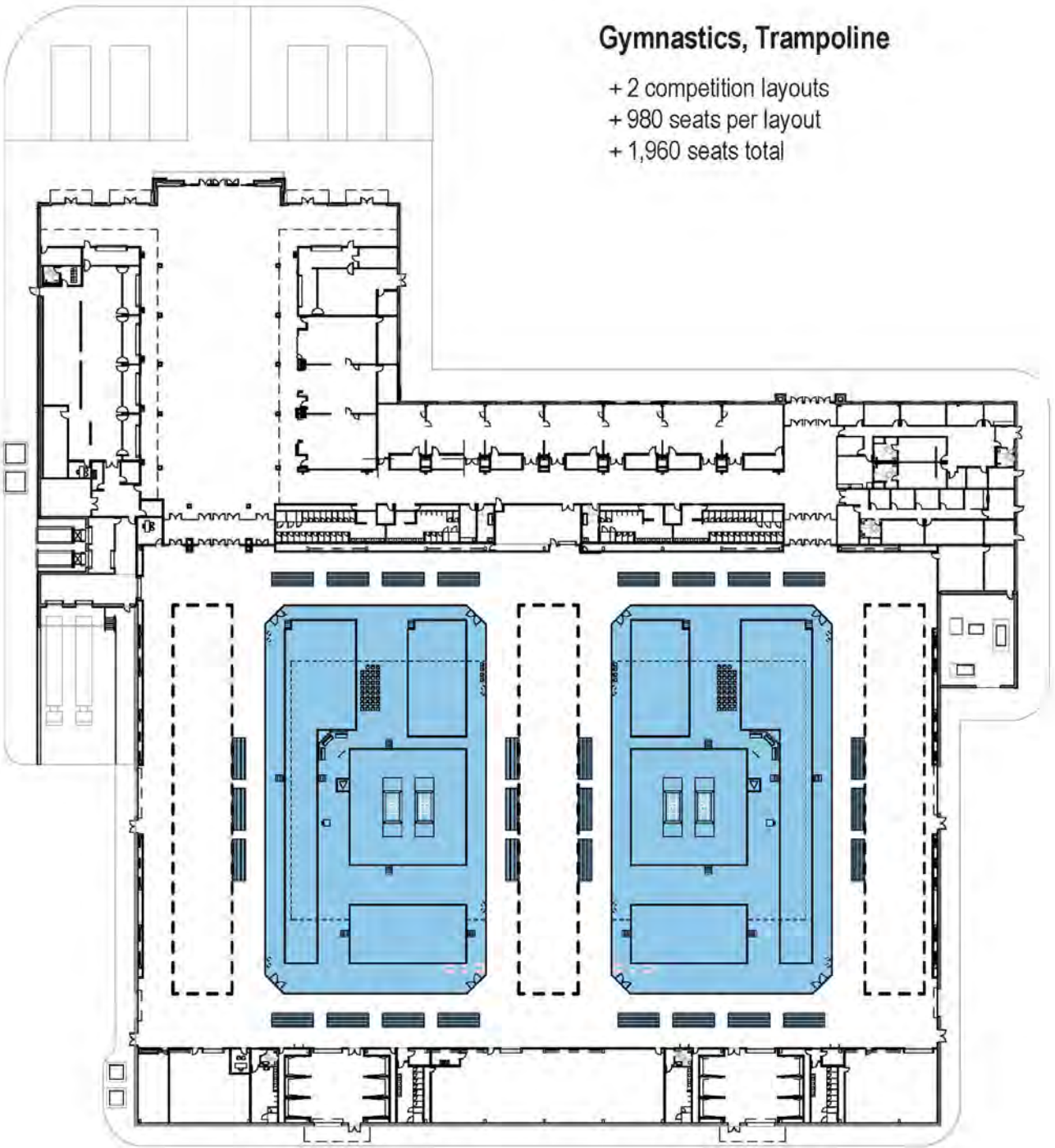



EVENT PLANS

Volleyball

- + 14 courts
- + 210 seats per court
- + 2940 seats total

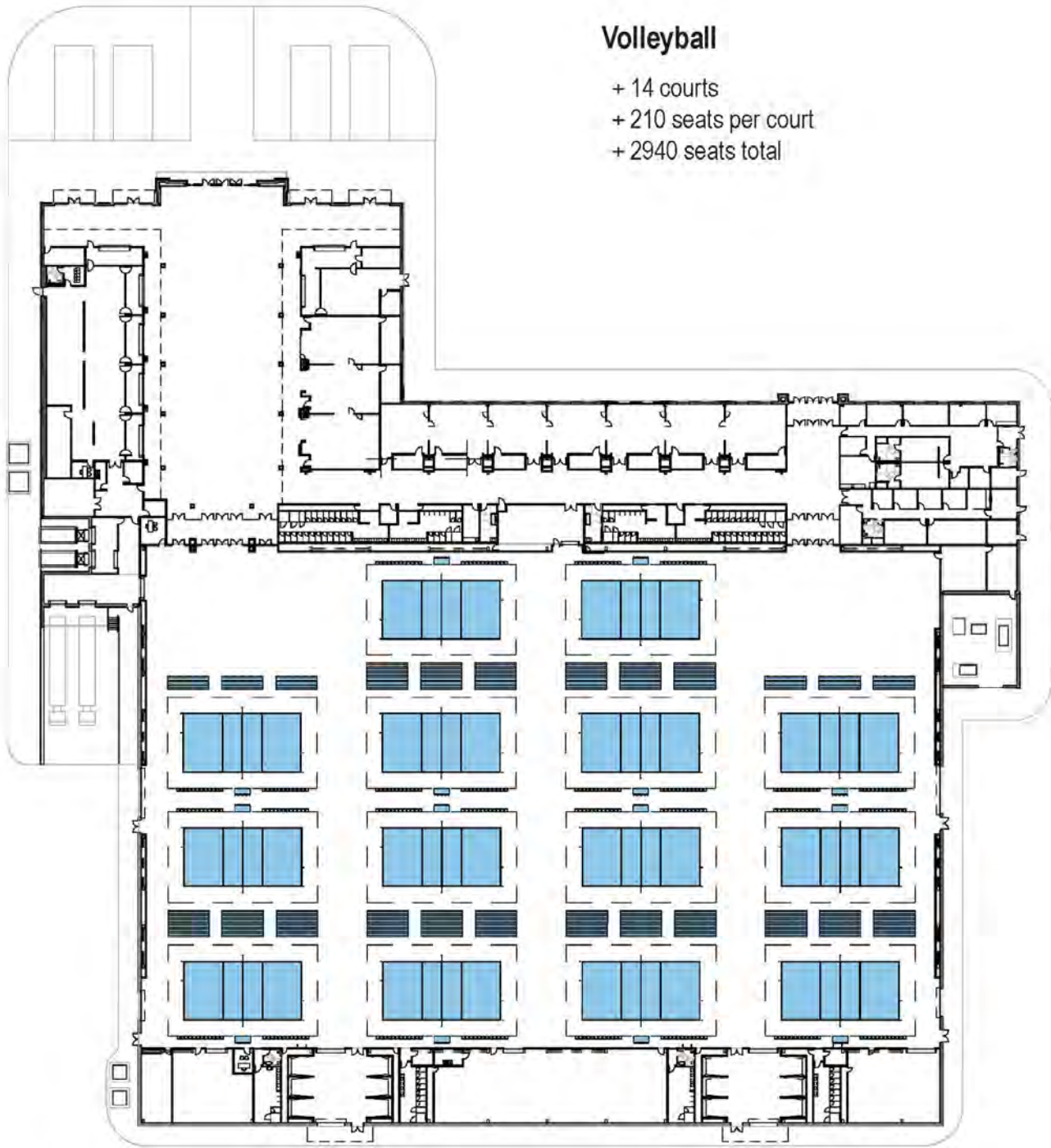

MULTIPURPOSE AG BUILDING

Indoor Soccer

- + 3 pitches
- + 700 seats per pitch
- + 2,100 seats total

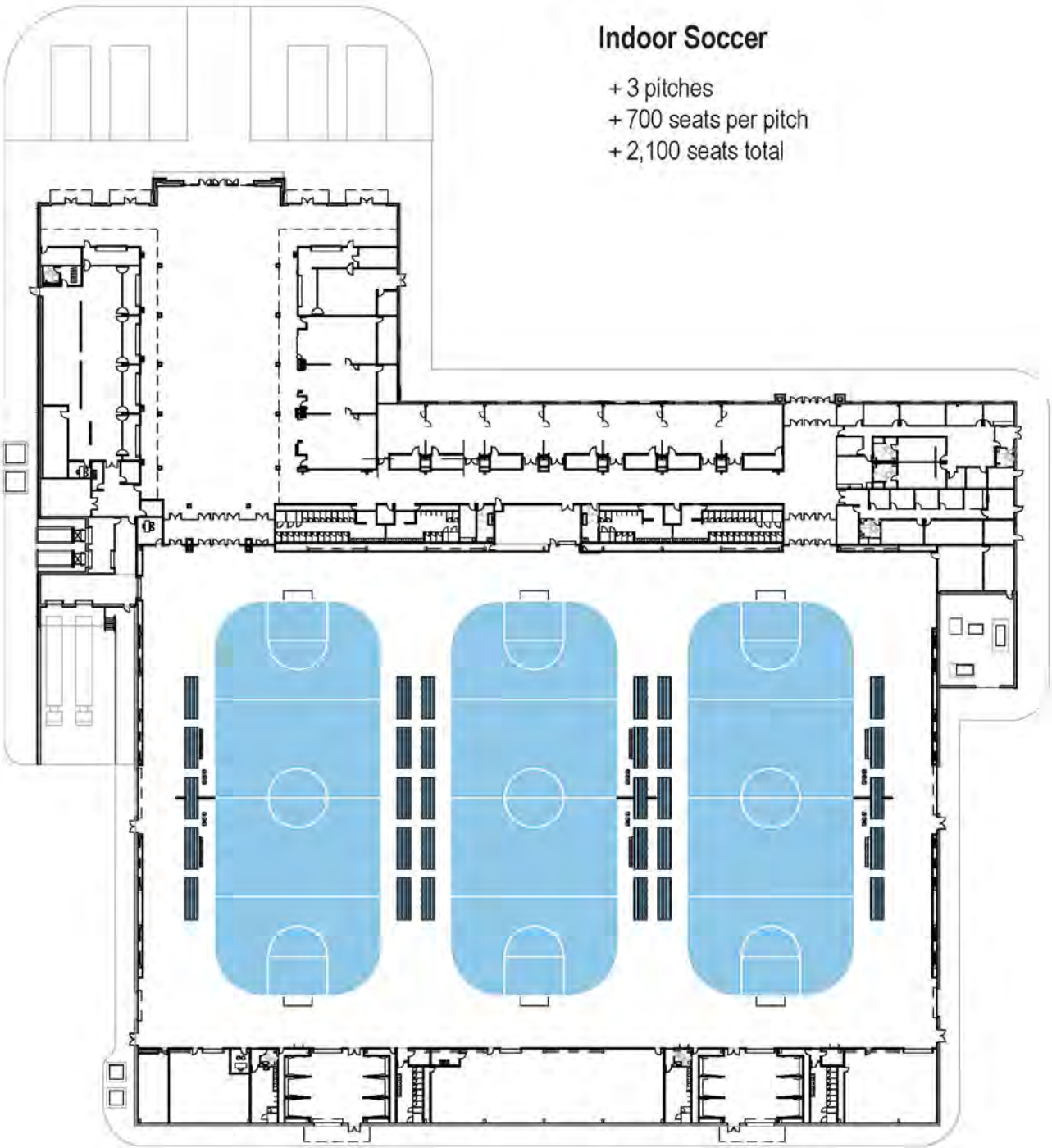



EVENT PLANS

Cheerleading

- + 22 competition mats
- + 140 seats per mat
- + 3,080 total seats

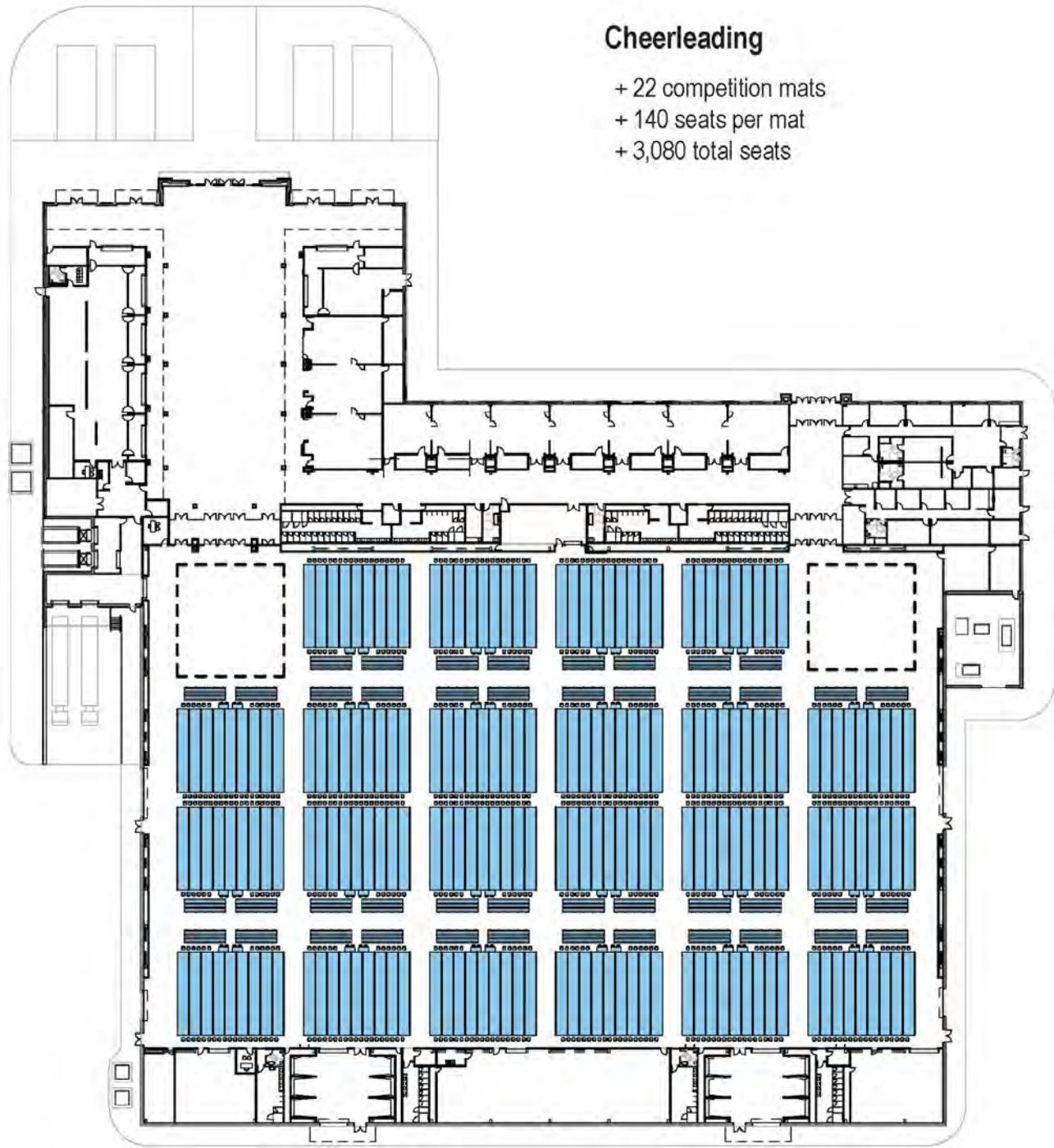

MULTIPURPOSE AG BUILDING

Fencing

- + 17 pistes
- + 140 seats per piste
- + 2,380 total seats

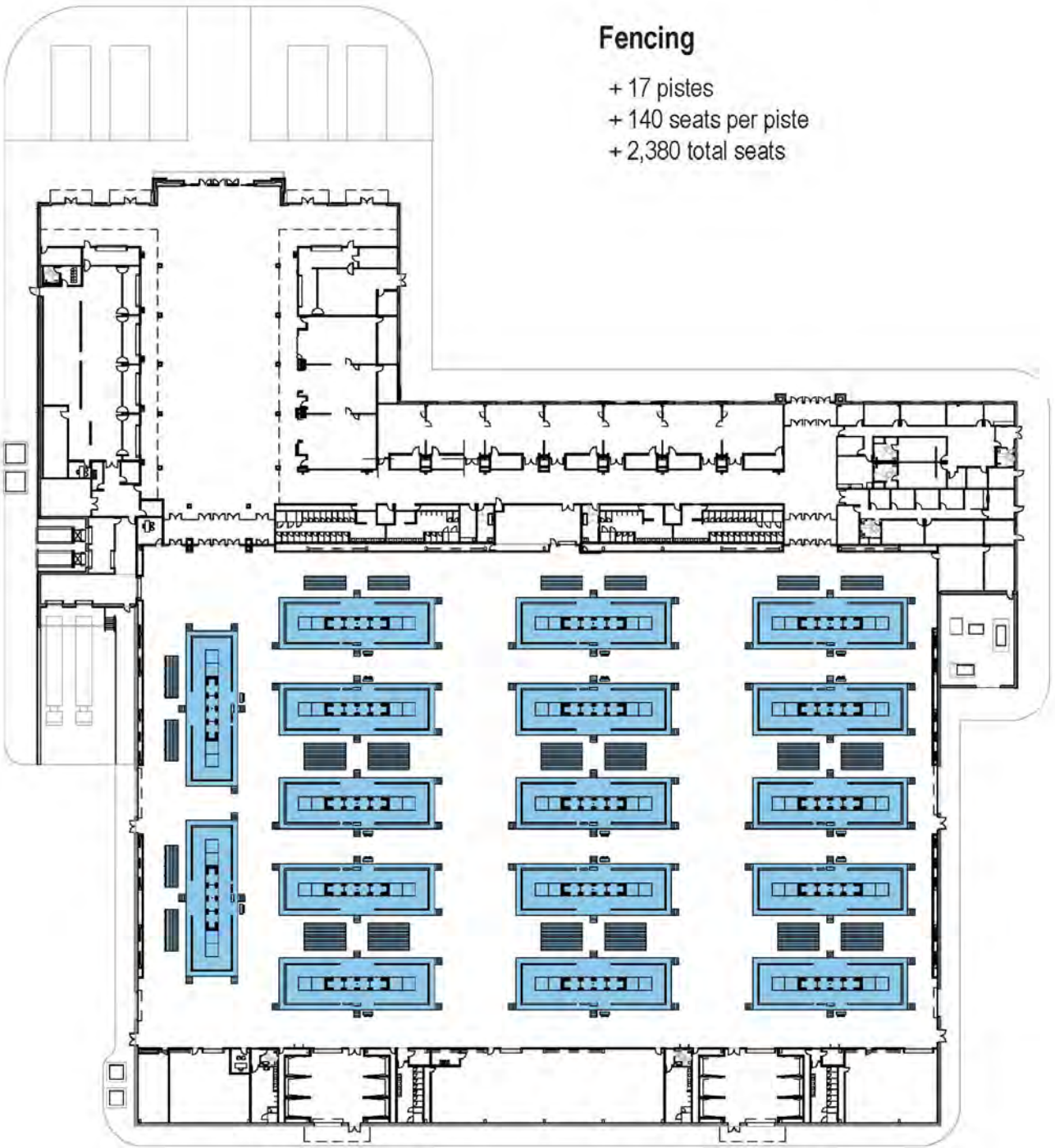



EVENT PLANS

Boxing

- + 8 fields of play
- + 700 seats per field of play
- + 5,600 seats total

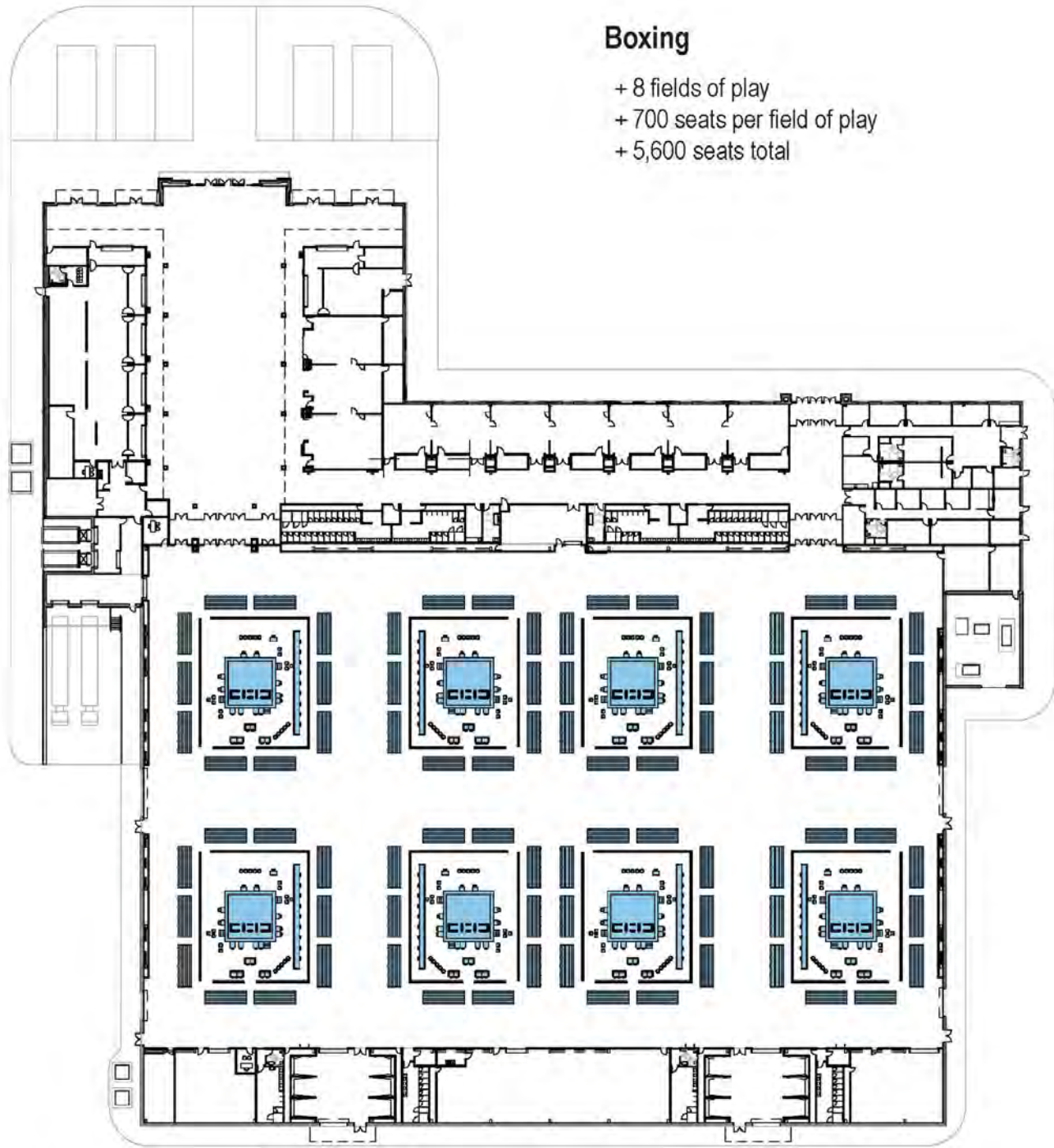

MULTIPURPOSE AG BUILDING

Taekwondo

- + 10 fields of play
- + 560 seats per field of play
- + 5,600 total seats

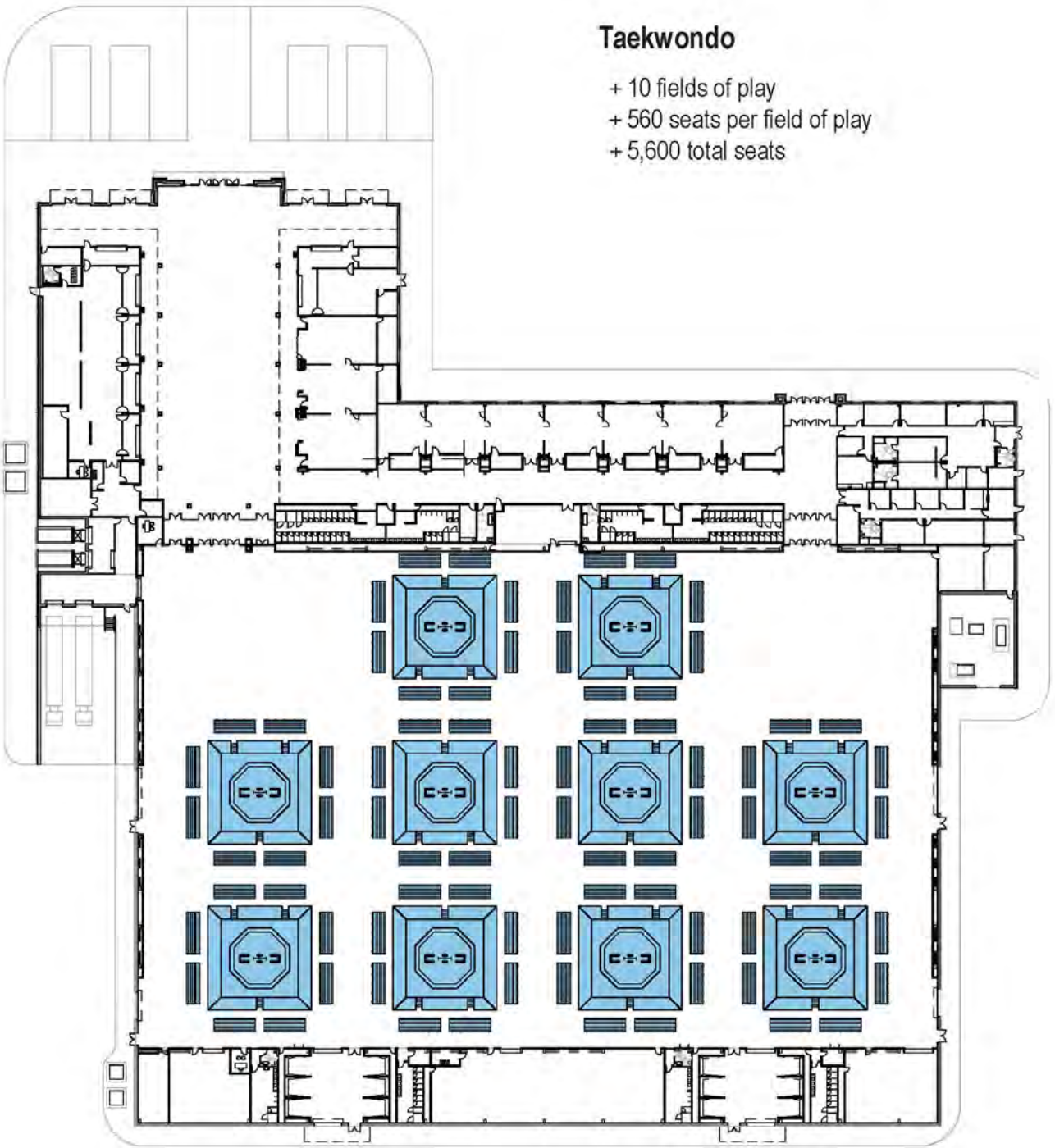



EVENT PLANS

Pickelball

- + 24 courts
- + 210 seats per court
- + 5,040 total seats

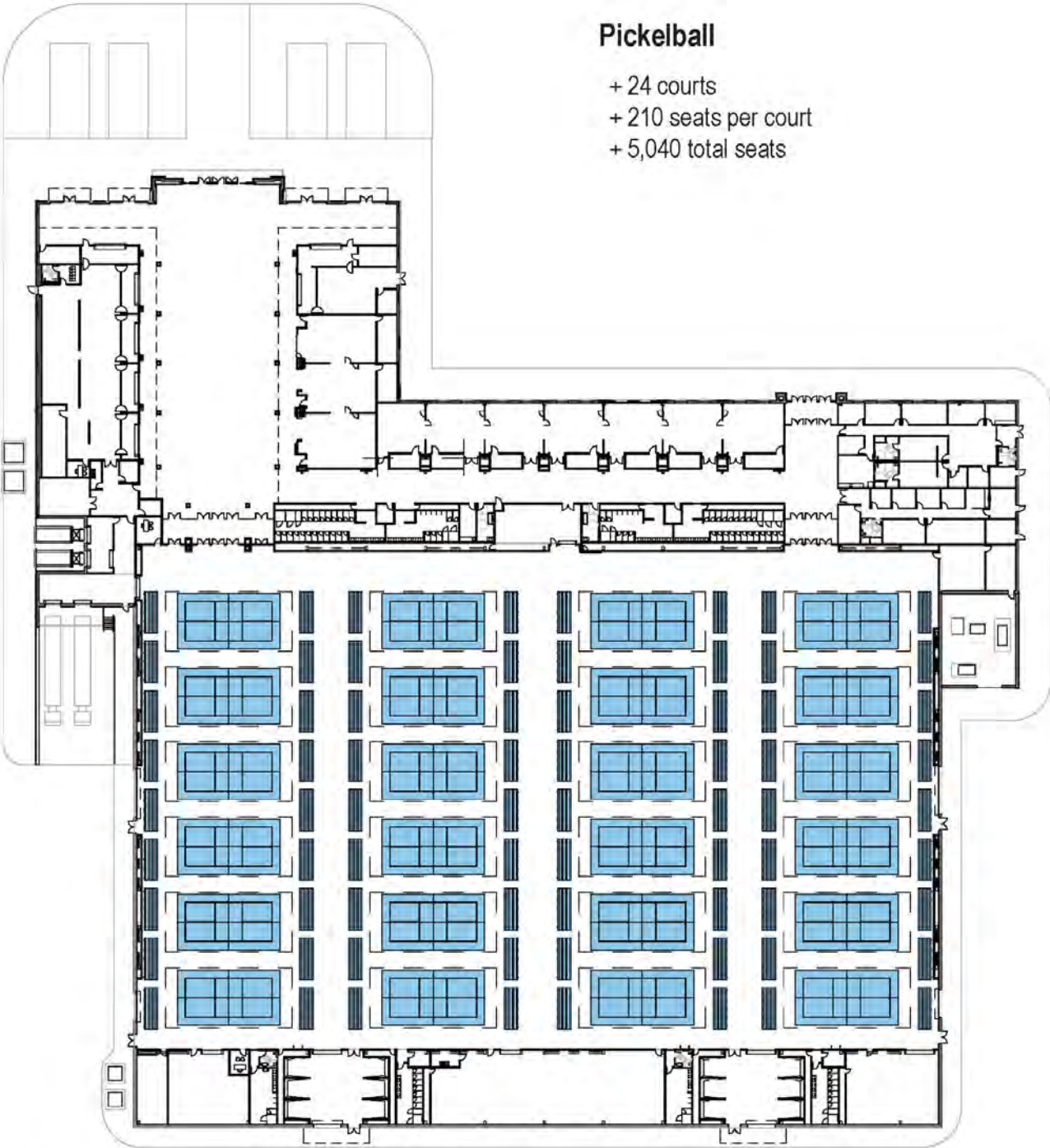

MULTIPURPOSE AG BUILDING

Table Tennis

- + 30 fields of play
- + 140 seats per field of play
- + 4,200 total seats

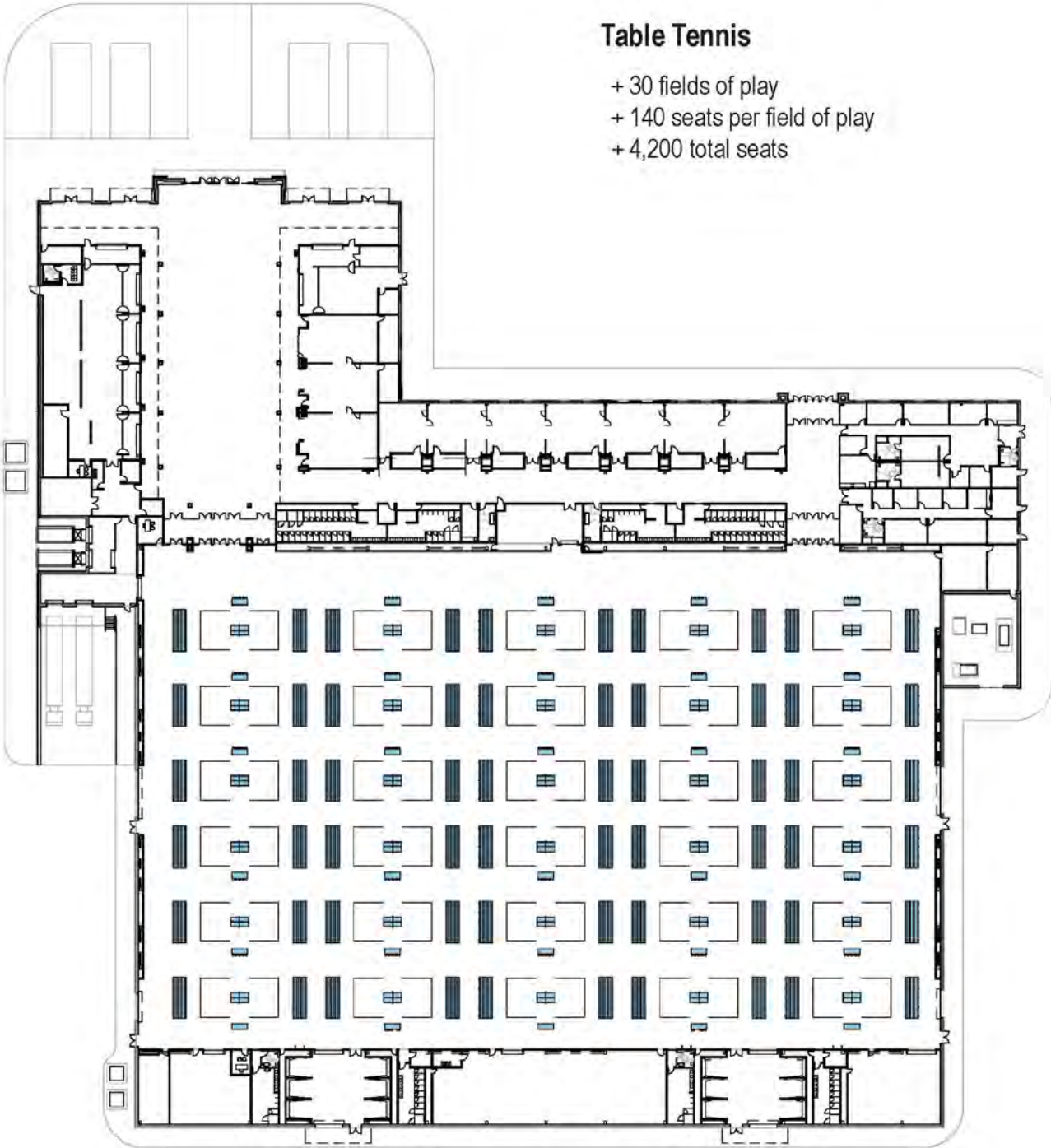



EVENT PLANS

Weightlifting

- + 12 fields of play
- + 210 seats per field of play
- + 2,520 total seats

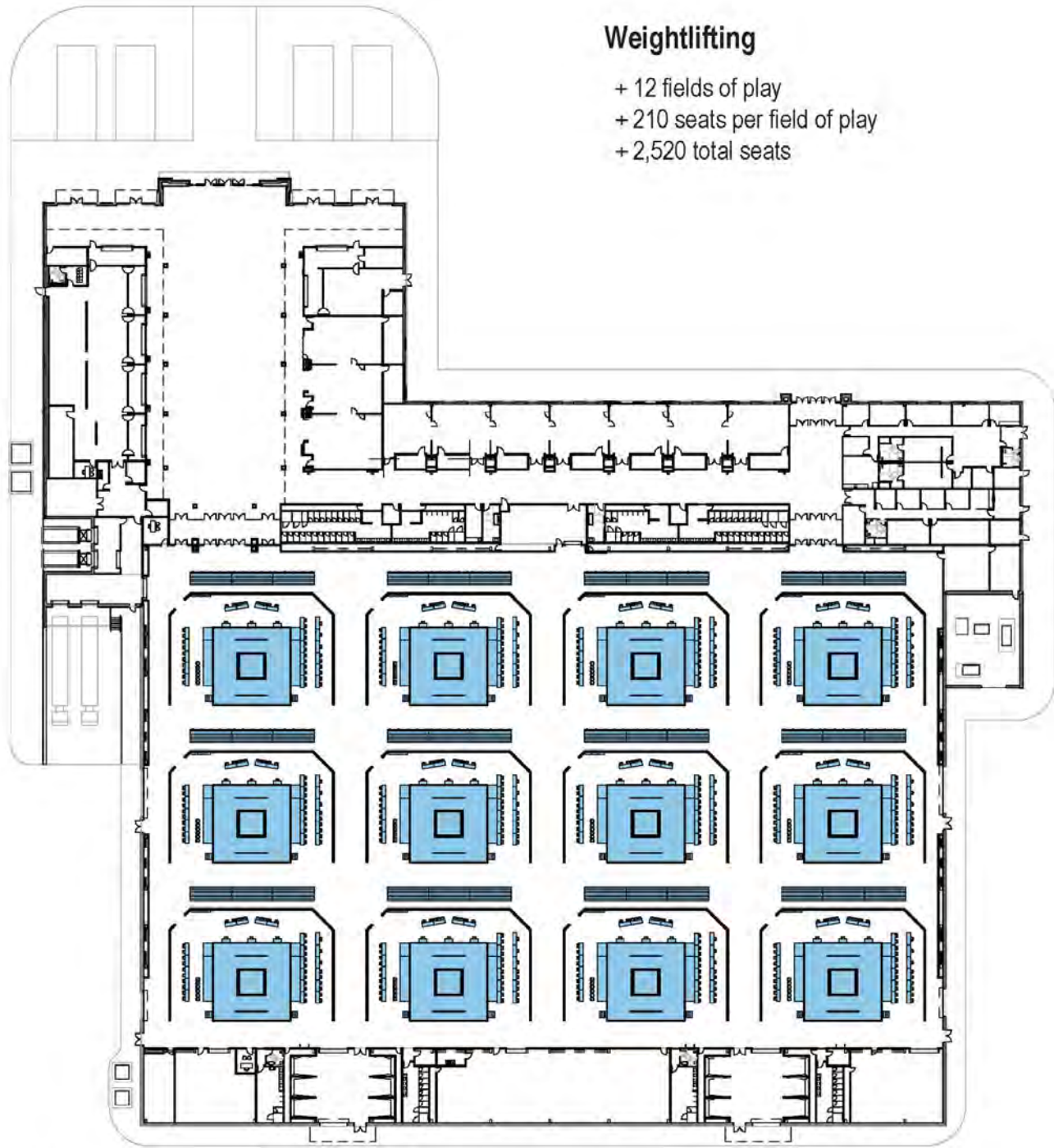

MULTIPURPOSE AG BUILDING

Wrestling

- + 12 fields of play
- + 175 seats per field of play
- + 2,100 total seats

